



Standard Accessory Kit

Accessory kits come standard with a carpet floor tool, handle, banded cuff, crevice tool, and dust brush combination.



Example of Inlet Kit

A standard inlet kit includes an inlet valve, wall plate and variety of bends and elbows.



Ask about other Hills Home Products

- Security Alarm Systems
- Unifone Telephone System
- Hills Home Music System
- Hills Home Hub
- Video Intercoms

For more information visit www.hillshomehub.com

Available From:



A Central Vacuum: the healthy choice





With asthma, eczema, and other allergies a common concern these days, you are actively reducing their triggers by installing a Hills Central Vacuum System, so your family is less likely to be troubled by these. The cleaning action is also more powerful than most conventional vacuums. The high-quality motor located in the main unit enables you to achieve a superior level of cleanliness in your home which your old vacuum could not.

The Healthy Choice

House dust mites live in our homes. The average pillow is home to approximately 10,000 dust mites. House dust mites are the most important source of allergens in house dust. Severe allergies, rhinitis (hay-fever like symptoms), eczema (skin inflammation) and asthma (respiratory disorder) are induced by the allergens these mites produce and affect 50 – 100 million people worldwide. However, dust mites are less troubling if their population levels remain low. (Department of Entomology, University of Queensland 1999 www.uq.edu.au/entomology/mite/dust.html). Conventional vacuum cleaners pass dust particles through the bag and filter, back into the air and your home. This dust will be suspended in the air you breath for days.

The Hills Central Vacuum System transports dirt & dust particles to the main unit by a series of pipes that are installed behind the walls or under the floor of your home. By venting the particles away from your living space, you are eliminating the circulation of dust & dirt throughout your home.



Maximising performance, comfort & convenience to you

The Hills Central Vacuum System provides you with a convenient way to keep your home clean. There are no bags to empty - the canister on the main unit only needs to be emptied a few times a year*. There are no electrical cords to trip over as you vacuum - inlets are placed in strategic positions around your home. All you need to do is plug in the vacuum hose into the inlet and the vacuum will automatically start. This reduces your vacuuming time. The vacuum will automatically stop once the hose is removed from the inlet. Storage of the head & hose takes up very little space, and its lightweight build means you don't have to cart a huge, heavy unit around the house as you clean. The hose comes with a sock, therefore less chance of injury to you and your furniture. This means there is less chance of injury to you and your furniture. The performance of a non-cyclonic vacuum cleaner will deteriorate as bags become clogged. This decline in cleaning power begins immediately a new bag is used for the first time. The Hills Central Vacuum's cyclonic separation method deposits the vast majority of dust and dirt particles into the canister before the airflow reaches the filter. The result is a near uniform cleaning performance from an empty to full dust bucket. The Hills Central Vacuum is also quiet in its operation as the motor and the noise is located away from the living space, in the main unit. So you can vacuum the house and not disturb your family as they watch TV, study, or use the telephone in the same room.

Ease of Installation

Your Hills Central Vacuum System is the ideal choice when building a new home. It can also be installed into most existing homes. The presence of a Central Vacuum System adds value to your home.

*Typically every 2-3 months.



Your Central Vacuum Accessorie

The Hills Central Vacuum comes with the highest quality accessories to maximise the cleaning performance of your system. A choice of attachments ensure that every tool you require to keep your home clean and healthy is available.

Vacuum Inlets

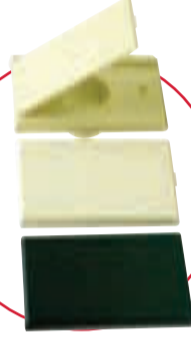

These are installed in strategic locations around your home so that all you need to do is plug in the hose piece. They are available in a variety of colours to compliment your home (Available in white, almond, ivory & black).

Telescopic Rod



The silver hose comes standard in a 10 metre length, with a hose sock which is inserted into any inlet throughout your home. This action automatically turns on your central vacuum system. The telescopic rod extends the reach (a 20 metre hose is available for coverage of a larger area). For convenient storage space, the hose hanger can be used to hold the hose.

Hose Hanger & Hose Sock



Upholstery Tool

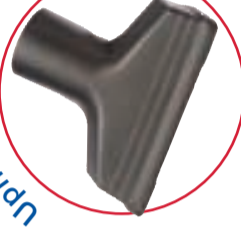

Carpet Tool



The carpet tool is designed for use on any carpet pile. It easily attaches to the handle on the vacuum hose or chrome telescopic rod.

Dry/Hard Floor Tool



This attachment is made for use on tiles, polished or parquet floors.

Brush Tool



The brush tool allows you to dust your furniture while you vacuum the house. It attaches to either the handle on the hose, or the telescopic rod.

Crevice Tool



Slim-line designed, the crevice tool allows you to vacuum those hard-to-reach places.

Speak to your provider about